



TD-6K

TD-1.5K
TD-3K

TD-12K
TD-50K

Screwdrivers Composition

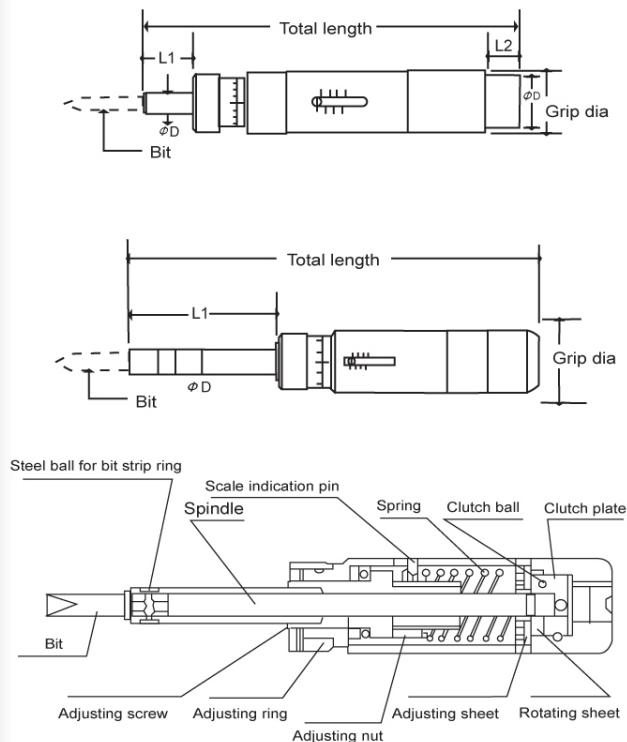

The above picture is kgf.cm type

Screwdrivers Assembling Line

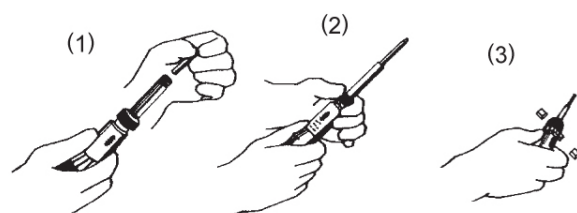

- (1) Select a bit to match screw.
- (2) Rotate the adjusting ring and set a torque.
- (3) Tighten the screw until idly rotated. Available for both left and right

Idly rotation prevents excessively tightening at the torque setting. Not wear out with a long time use.

- Light and short, easy to operate, and favorable sound touch sensibility at idly rotation.
- Set up required torque value and tightened, everyone can tighten in the same way.
- When reaching specified torque, the clutch will be released automatically, and idly rotated, therefore this action prevents excessively tightening.
- (+) and (-) bit 1pc, respectively are attached.
- Various bits are prepared.
- Used for both left and right turns.
- Max. accuracy $\pm 3\%$ and 1 scale assured.

Specification

Model LTDK	Torque	Grad.	Grip Dia.	Total Lenght (without bit)	Main Size(mm)				Weight	Attachment Bit		
	kgf.cm		Φmm	mm	L1	L2	ΦD1	ΦD2	g	⊕	⊖ (thicknessXwidth)	
TD-1.5K	0.1~1.5	0.01	18	86	8.5		8		45	No.1	0.4X3.5	Original
TD-3K	0.2~3	0.02										
TD-6K	0.5~6	0.05	25	106	36	10		19	90	No.1 (4Φ)	0.4X0.4	Common with marketed products
TD-12K	2~12	0.1	30	140	39.5	8.5		24	150			
TD-20K	4~20	0.1	34	150	60		10		210	No.2 (7Φ)	1.0X7.0	
TD-30K	4~30	0.1							215			
TD-50K	10~50	0.25	40	200	73	11			440			
TD-100K	20~100	0.6	45	235	100				790			